



SunRise Solar-Powered Attic Fan

Flat Base Unit

Installation Guide



Available Models:
FB 850 FT, FB 1050 FT, FB 1250 FT

For sloped, shingled roofs.



SunRise Solar Attic Fans
P.O. Box 53
St. John, IN 46373
219-558-2211
www.SunRiseSolar.com

Made in the USA



FLAT BASE UNIT INSTALLATION

NOTE: For best operation, install solar fan where it will receive direct sunlight. South or West facing roof slopes will work best.

- 1.) Cut a 14 1/2" diameter hole between rafters approximately 24"-30" down from roof peak to center of hole.

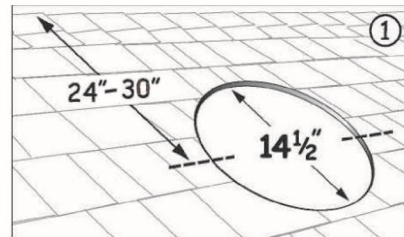

- 2.) Trim away top rows of shingles an additional 2" to allow base flashing to slip under top rows of shingles and over bottom rows.

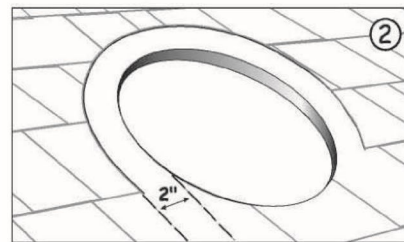

- 3.) Slip the flat base under the top rows of shingles and center unit over opening with the SRS Logo on the bottom.

- 4.) Gently lift the unit and apply sealant under lower edge and sides of base flashing.

- 5.) Pre-drill (4) mounting holes along the bottom edge of the base flashing, and (1) hole on each side approximately 2" up from the bottom edge.

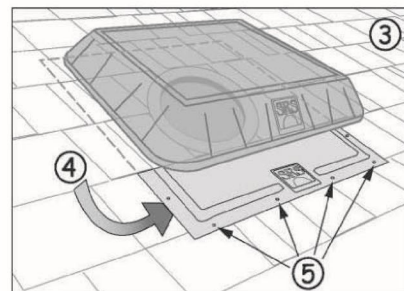

- 6.) Use exterior-grade screws to secure unit to roof deck. Apply sealant to screw heads.

DO NOT OVER-TIGHTEN SCREWS



Fixed Thermostat Information

This fan has been factory equipped with a thermal on/off switch. This switch is designed to turn the fan:

ON: 80° F
OFF: 65° F
(+/-7°)



Example: Attic temperature rises to 80° and fan turns on. Once it cools to 65° the fan will shut off. If evening comes and temp does not fall below 65° to reset the switch, then the unit will start the next morning at sunrise and continue to cool the attic. However, if the attic temp falls below 65° at night, then the switch will shut off and will not turn the unit on again until attic temp reaches 80°.

INSTALLER: THIS FAN WILL NOT RUN UNLESS THE AMBIENT (AIR) TEMPERATURE IS AT OR NEAR 80°. YOU MAY TEST OPERATION OF THE THERMOSTAT BY BLOWING WARM AIR DIRECTLY ON THE THERMOSTAT TO HEAT IT TO 80°, MAKING SURE SOLAR PANEL IS EXPOSED TO SUNLIGHT AT THE SAME TIME.